

# PNEUMATIC ACTUATORS

## Double Acting

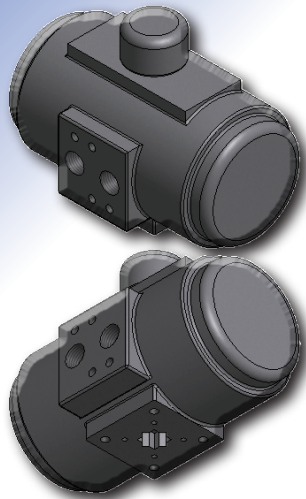

DMIC Double Acting actuators give you control to open and close a valve remotely and rapidly. Double Acting actuators are an economical solution for difficult to reach or isolated environments or where properly equipped, in hazardous or explosive environments. Double acting actuators will keep the valve in the open or closed position until energized to move. They can be fitted with accessories such as limits switches or electronic position indicators

- Rapid response
- Multiple sizes with various torque ranges
- 120 PSI MAX input rating

Actuators	MAX PSI Rating	Dimensions (inches)																			
		A	B	C	D	E	F	G	H	J	K	L	M	N	P	Q	R				
AC-DAA	120 PSI	2.36	1.30	4.06	0.83	2.36	0.90	0.36	N/A	1.654	10-24 X 0.24	N/A	0.47	1.00	10-24 X 0.24	1/8 NPT	0.50				
AC-DAB		3.27	1.81	6.26	1.26	3.15		0.44	1.969	1.417	10-24 X 0.31	1/4-20 X 0.39									
AC-DAC		3.79	2.09	7.09	1.32	3.66		0.56	2.756	1.969	1/4-20 X 0.39	5/16-18 X 0.39									
AC-DAD		4.19	2.26	7.83	1.54	4.13	0.75	4.016	2.756	5/16-18 X 0.39	3/8-16 X 0.63										
AC-DAE		4.61	2.48	8.70	1.59	4.65	0.87														
AC-DAF		5.39	2.87	11.14	1.99	5.63	1.07	4.921	4.016	3/8-16 X 0.63	1/2-13 X 0.79										
AC-DAG		7.12	3.71	12.01	2.85	7.13	1.29	0.35	N/A	1.417	M5	N/A									
AC-DAH		8.53	4.45	15.24	3.33	8.66															
AC-DAM		1.77	0.89	4.65	0.89	1.77	0.55	0.43	1.970	1.420	10-24 X 0.29	1/4-20 X 0.35						0.63	M5	1/8 NPT	N/A
AC-DAN		2.79	1.61	5.49	1.04	2.74	0.94	0.67	2.760	1.970	1/4-20 X 0.31	5/16-18 X 0.47									
AC-DAO		3.17	1.77	6.38	1.08	3.17															
AC-DAP		3.72	2.07	8.15	1.38	3.82	0.87	4.020	2.760	5/16-18 X 0.47	3/8-16 X 0.55										
AC-DAQ		4.17	2.30	9.35	1.65	4.27	1.06	4.920	4.020	3/8-16 X 0.59	1/2-13 X 0.71										
AC-DAR		4.85	2.68	10.69	1.97	4.78	1.53	1.42	5.510	N/A	N/A	5/8-11 X 0.98									
AC-DAS		5.39	2.87	12.91	5.57																
AC-DAT		5.83	3.15	14.41	2.40	6.04															
AC-DAU		6.45	3.44	16.85	2.80	6.93															
AC-DAV		7.36	3.94	20.55	3.21	7.40															
AC-DAW		8.58	4.29	22.64	3.46	9.41															

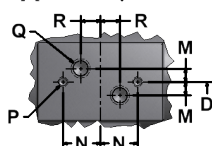
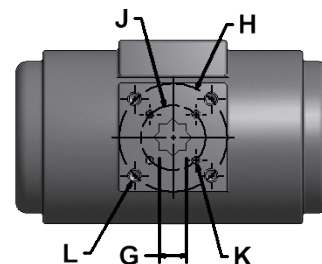
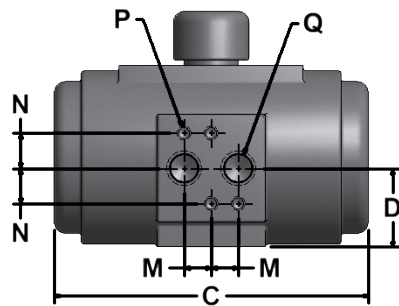
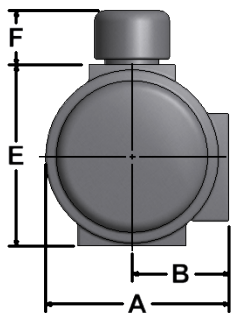

AC-DAA & AC-SRA4  
PORTING

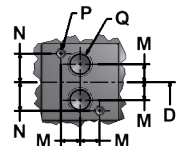

AC-DAW & AC-SRW4  
PORTING

**Due to our policy of continual product improvement, the specifications in this catalog may change without notice. When designing by spec, please request a certified print.**



# PNEUMATIC ACTUATORS

## Double Acting

### Order Codes

AC — DA\*

AC Series	
Code	Range
DA*	Please replace (*) with the actuator size located on previous page

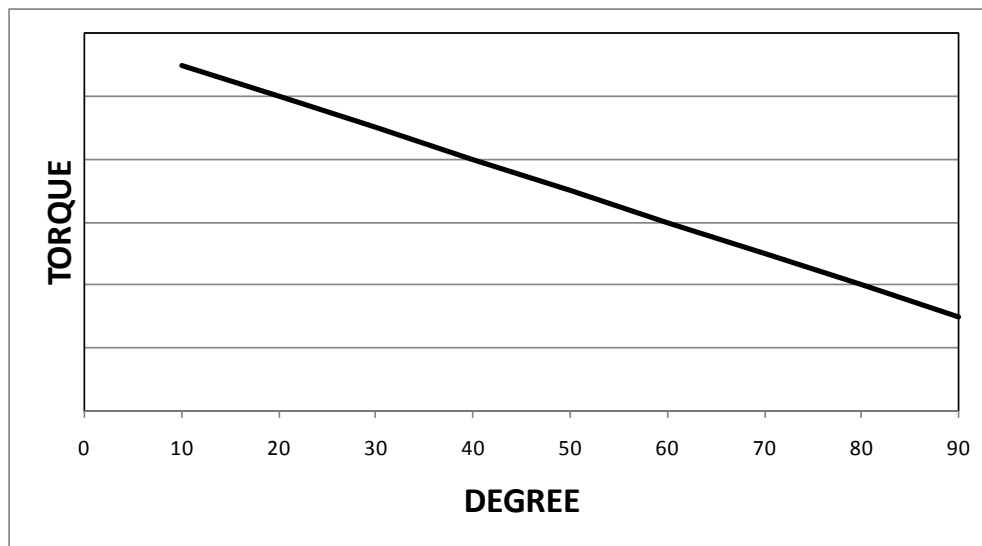

Please consider the following questions when choosing the right Double Acting Actuator for your system:

- Ball Valve Part Number or Bore Size
- Fluid Type
- Maximum and Minimum pressure
- Temperature (System + Ambient)
- Maximum and Minimum air supply pressure
- Duty Cycle: Cycles per Second/Minute/Hours/Days
- Will the valve be actuated under load due to pressure
- Environment exposure (marine, hazardous location, etc...)
- Please tell us any special conditions or requirements

**Due to our policy of continual product improvement, the specifications in this catalog may change without notice. When designing by spec, please request a certified print.**



# PNEUMATIC ACTUATORS

## Double Acting

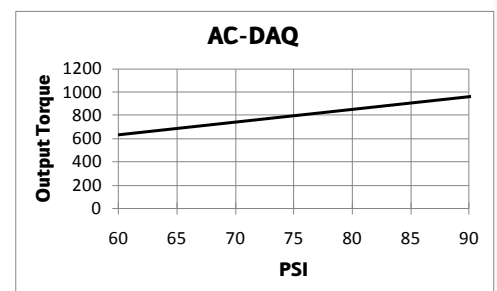
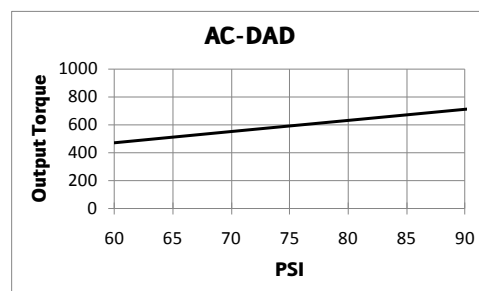
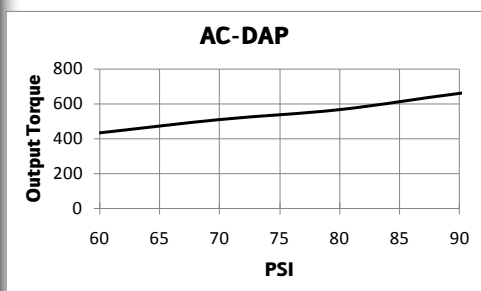
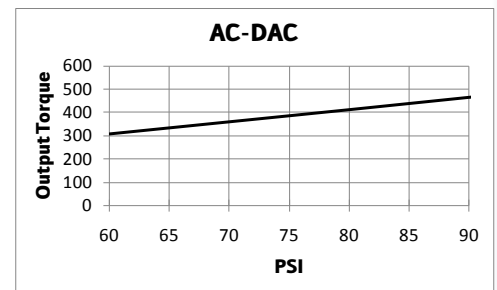
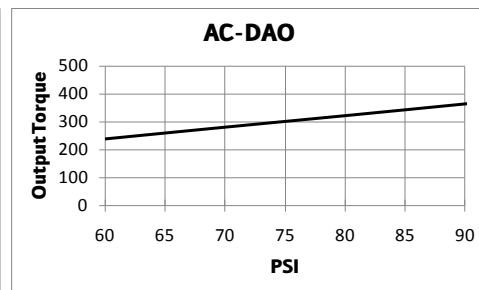
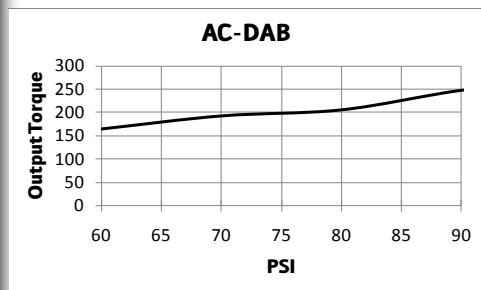
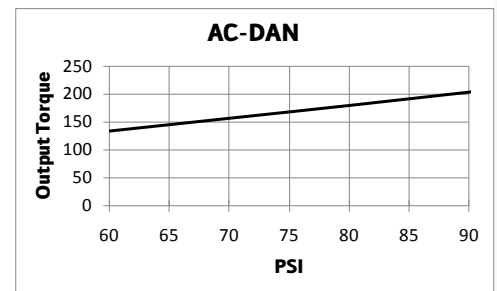
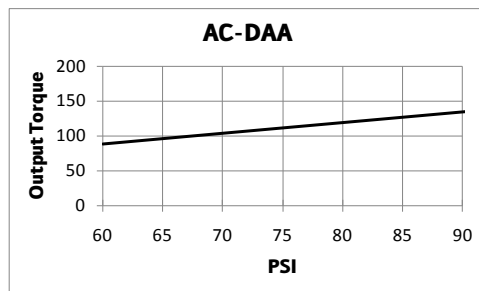
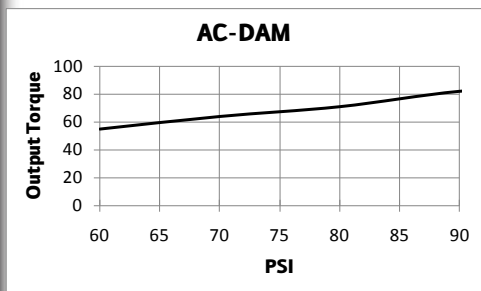
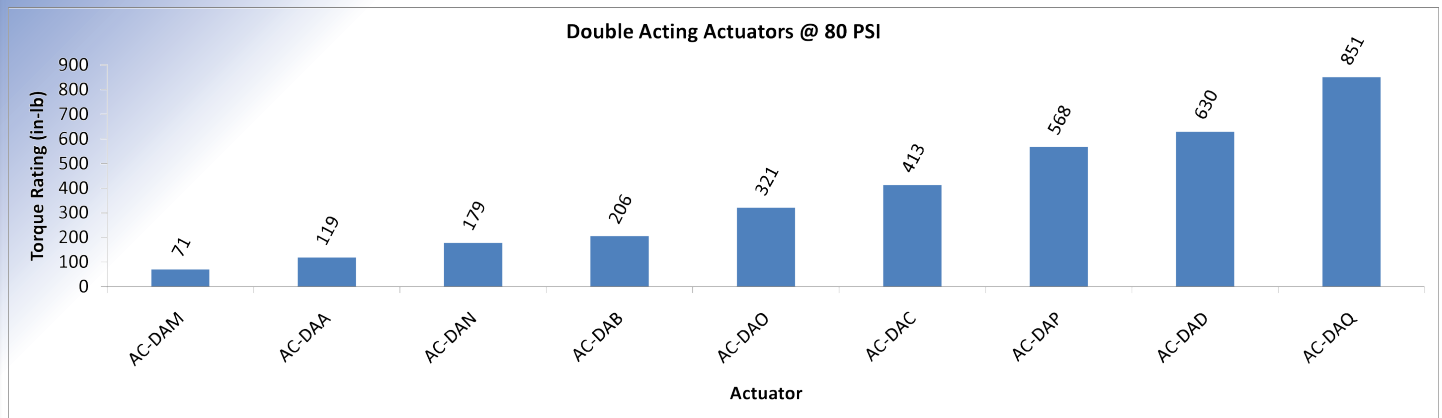

*Due to our policy of continual product improvement, the specifications in this catalog may change without notice. When designing by spec, please request a certified print.*



# PNEUMATIC ACTUATORS

## Double Acting

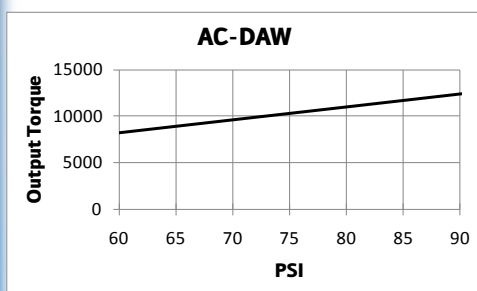
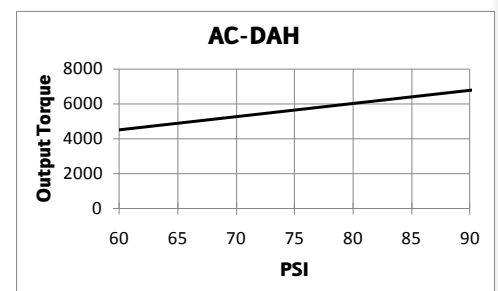
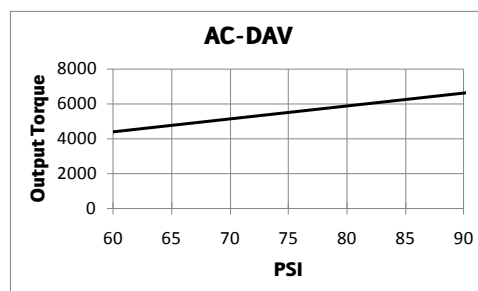
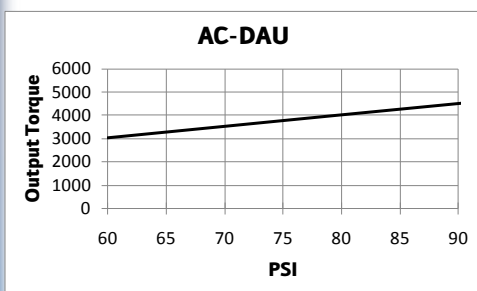
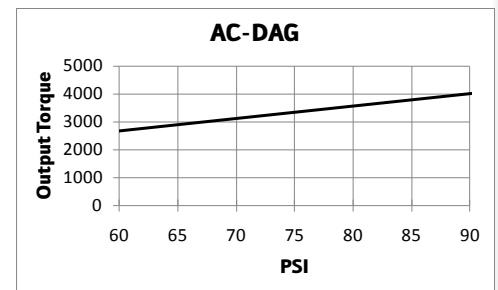
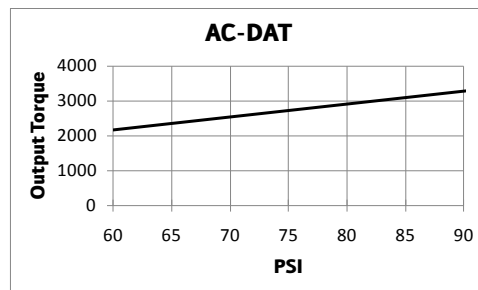
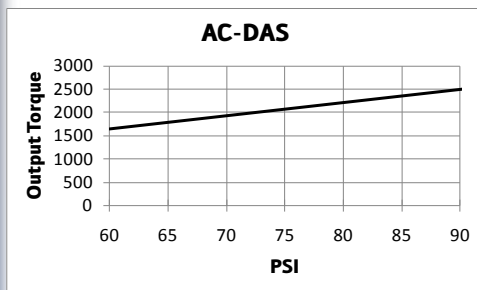
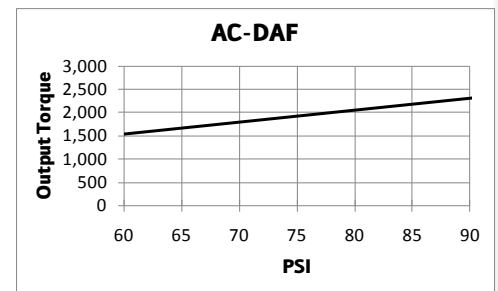
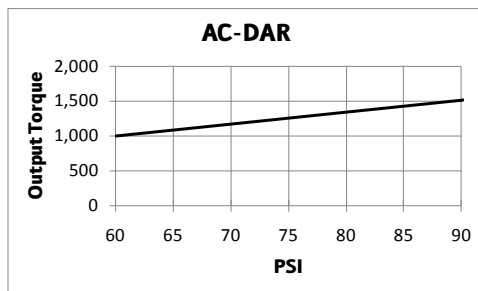
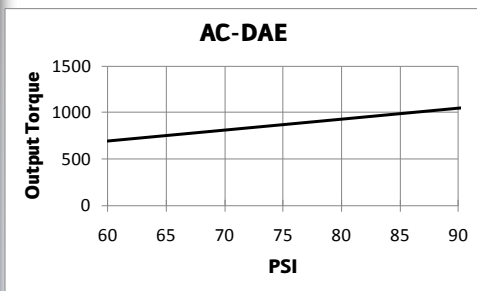
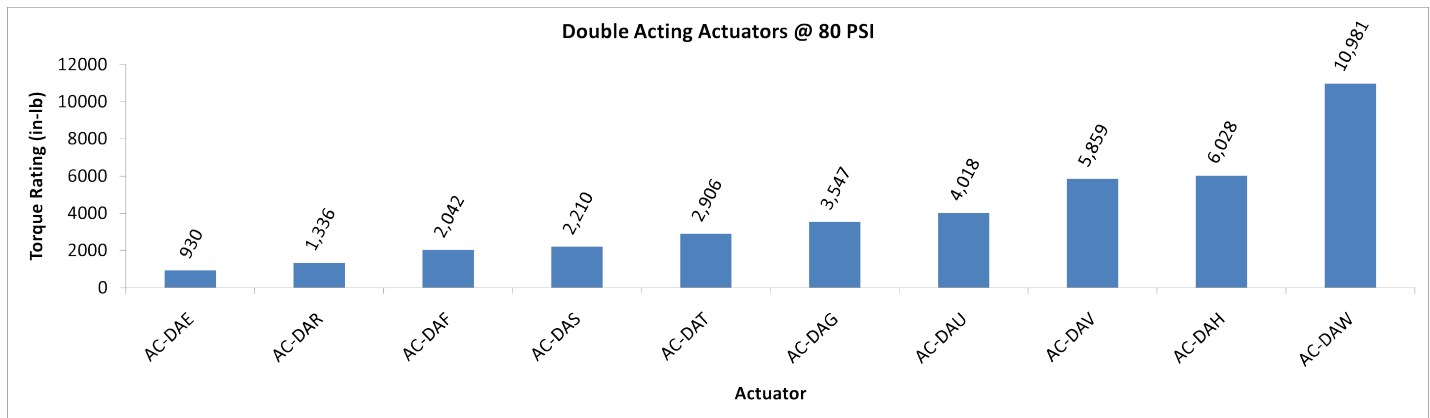

*Due to our policy of continual product improvement, the specifications in this catalog may change without notice. When designing by spec, please request a certified print.*

