

BVQ/BVQG 6000 PSI

Raises every standard: thermal, quality, durability ; -20°F to 400°F
High Quality Stainless Steel Fluid & Gas Valves ½" to 6"



BVQ

- All 316 Stainless steel construction standard.
- Standard sizes range from ½"-6" bore; Call for sizes greater than 2" bore.
- Designed for demanding applications where high performance & quality are required
- 6,000 PSI with generous design factor to eliminate damage due to pressure spikes.
- Wide variety of bolted end connections ideal for heavy industrial applications.
- Isolated spindle allows for use of 316 spindle without metal-to-metal contact; ideal for applications requiring an actuator.
- Standard High Temperature Peek ball seals & Viton™ seals. Other materials available for full fluid compatibility range.

BVQG ~ Gas Applications

- Improved ball seals specially designed for gas applications.
 - Special material coatings improves life expectancy in dry environment.
- * *Please note:* For valves larger than 2", large pressure differentials may make the valve difficult to open and the pressure balance may be required. Ask your DMIC sales Associate for more info!

Service Parts BOM

BVQ/G SERVICE PARTS BOM		
Index	Qty	Description
1	1	VALVE BODY
2	1	BALL
3	1	SPINDLE
4	2	BALL SEAL
5	2	END CONNECTION
6	2	END CONNECTION O-RINGS
7	1	INTERNAL THRUST WASHER
8	1	SPINDLE O-RING
9	1	EXTERNAL GLIDE WASHER
10	1	STOP PIN
11	1	STOP WASHER
12	1	TOP CAP
13	*	TOP CAP MOUNTING BOLTS
14	1	HANDLE
15	1	COLOR CODED TOP CAP
16	1	COLOR CODED TOP CAP BOLT
17	1	UPPER SPINDLE BUSHING
18	1	TOP CAP O-RINGS
19	1	LOWER SPINDLE BUSHING
20	*	END CONNECTION MOUNTING BOLTS

BVQ shown, BVQG has O-Ring behind each seal
 * Depends on size

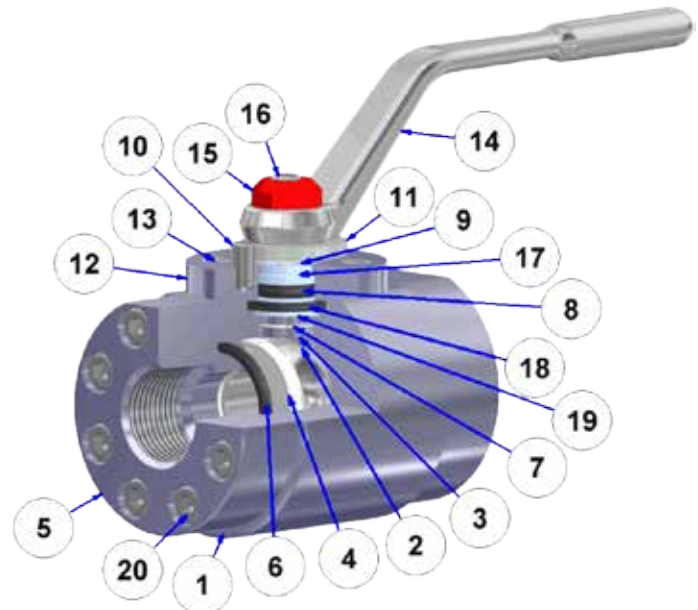

BVQ/BVQG 6000 PSI

Ordering Codes Summary

Size Codes	
Code	Port Size
0500	½"
0750	¾"
1000	1"
1250	1 ¼"
1500	1 ½"
2000	2"
2500+	2 ½" - Call

**All sizes are reduced Bore please check dimensional chart.*

Call Factory for larger sizes 18"+

BVQ
or
BVQG

S

2

2

4

3

See page 14 for accessory codes

* * * * *

Connection Types	
Imperial Threads	
Code	Description
S	SAE ORB
N	NPT
Metric Threads	
B	BSPP
ISO Threads	
IU	ISO6149
Welded	
W*	Socket Weld
WB*	Butt Weld
Flanged	
A*	ANSI Flanges
F*	SAE 4-Bolt UNC
G*	SAE 4-Bolt Metric
S*	SAE Split

O-Rings	
Code	Description
1	Buna-N
2	EPR
3	Viton™
5	Chemraz™
6	Kalrez
7	Buna-3716 (Low Temp)

Seals, Bushings, Washers	
Code	Description
1	Delrin™
4	High Temp Peek
6	Delrin™ AF (low Friction)

Ball & Spindle	
Code	Description
2	Stainless Steel - 316
6	416 Stainless Spindle 316 Stainless Ball

Body & End Connections	
Code	Description
1	Carbon Steel - ASTM A108
2	Stainless Steel - 316

Note: Changes to Sealing Materials may result in changes to temperature and/or pressure rating.

Due to our policy of continual product improvement, the specifications in this catalog may change without notice. When designing by spec, please request a certified print.



BVQ/BVQG 6000 PSI

BVQ/ BVQG	Port Size	Rated Pressure PSI	Dimensions						
			A Length	B Body Diameter	ØC Bore	D Handle Length	E Height	F Bottom to Center	G Center to Cap
For Threaded Connection Type									
BVQ-0500****	½"	6000	3.31	2.25	0.38	4.50	3.90	1.13	1.94
BVQ-0750****	¾"		4.35	2.75	0.56	7.00	5.35	1.25	2.67
BVQ-1000****	1"		4.60	3.25	0.81	7.00	5.83	1.63	2.77
BVQ-1250****	1¼"		5.27	4.22	1.10	9.86	7.49	2.11	3.51
BVQ-1500****	1½"		5.35	4.50	1.31	9.86	8.07	2.25	3.95
BVQ-2000****	2"		6.58	4.97	1.75	9.86	8.62	2.50	4.24

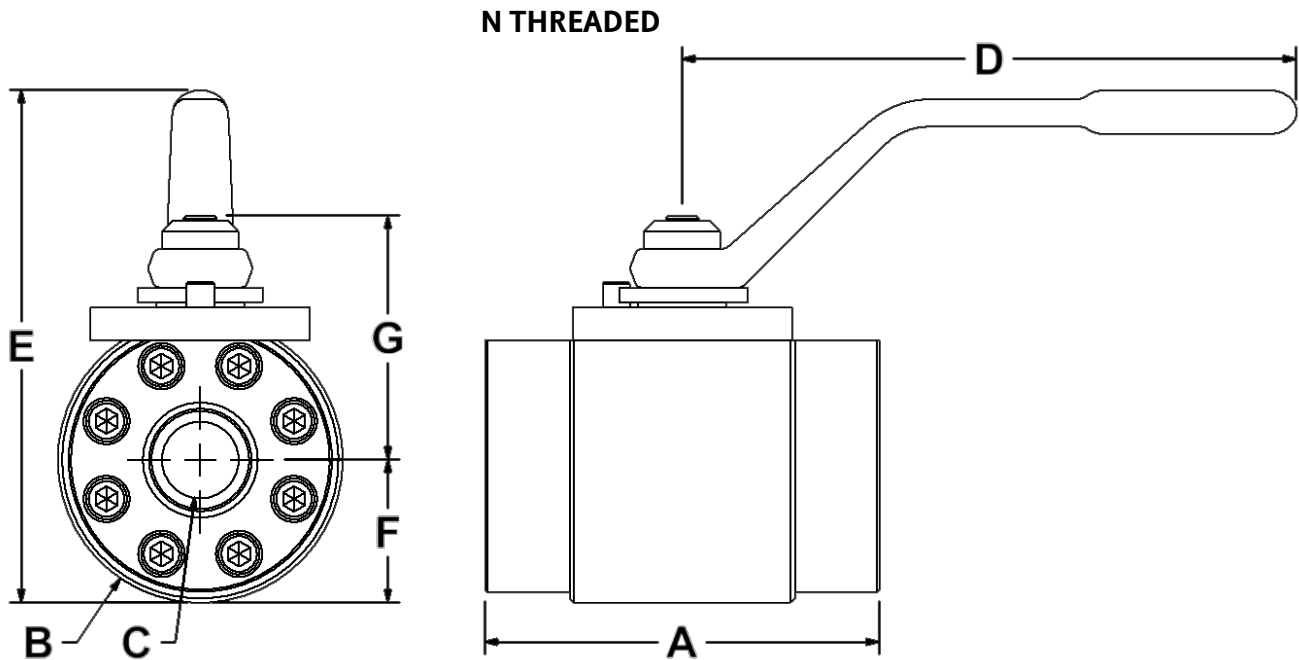

BVQ/BVQG 6000 PSI

Flow Characteristic and Actuation Torque Curves

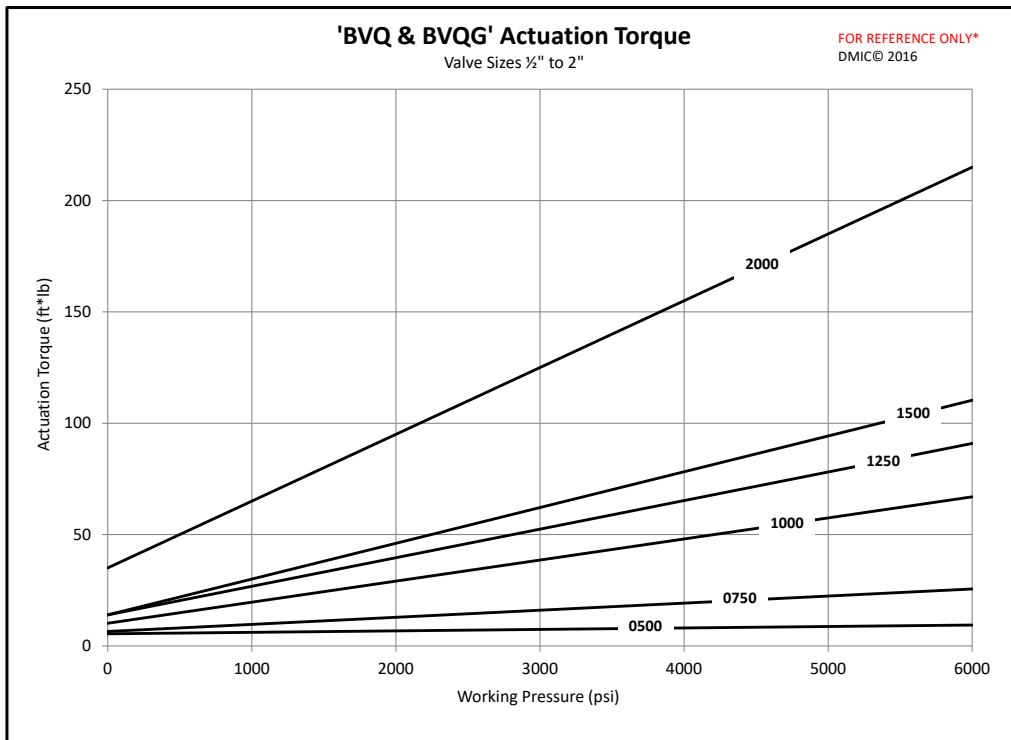
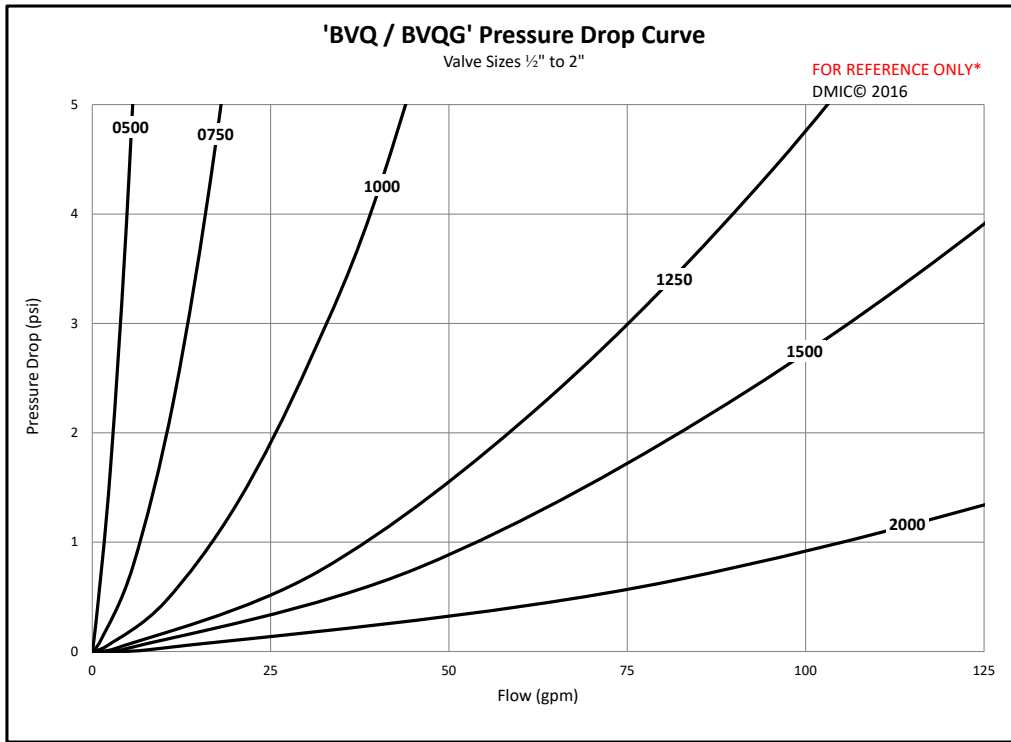

Due to our policy of continual product improvement, the specifications in this catalog may change without notice. When designing by spec, please request a certified print.

