

# ESB Barb to S/F Head 45°

A direct connection to your pump's inlet



The ESB 45° elbows are an elegant routing tool for specific pump to reservoir geometries. Quick order with a Split Flange Kit for a fast and easy solution.

- Standard SAE Flange Head mounts with C.61 Split Flange Kit to your pump's 4-Bolt Companion Pad.
- Smooth bend radius aids laminar flow and reduces pressure drop.
- Optional oversize barb allows designers to preserve nominal line ID even on the hose segment.
- Made in U.S.A. for rapid delivery, even in Stainless Steel.
- Suction to 400 PSI.
- Carbon Steel part number, see catalog F04 for other options.

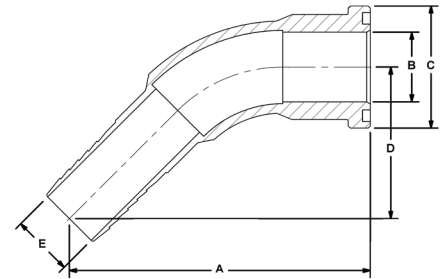
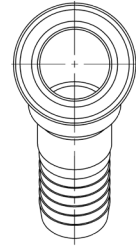

<b>ESB</b>		<b>Barb to Split Flange Head, 45° Elbow</b>					
<b>Port Codes</b>	<b>Port Size</b>	<b>Dimensions IN</b>					<b>Split Flange Kit (Carbon Steel)</b>
		<b>A</b>	<b>B</b>	<b>C</b>	<b>D</b>	<b>E</b>	
<b>HB HM SM</b>	¾"	4.08	0.75	1.50	2.08	0.63	FSL-0750SK
	1"	4.30	1.00	1.75	2.17	0.88	FSL-1000SK
	1¼"	4.90	1.25	2.00	2.65	1.00	FSL-1250SK
	1½"	5.11	1.50	2.38	2.74	1.28	FSL-1500SK
	2"	5.86	2.00	2.81	3.23	1.75	FSL-2000SK
	2½"	7.39	2.50	3.31	3.89	2.25	FSL-2500SK
	3"	8.29	3.00	4.00	4.42	2.75	FSL-3000SK
	4"	9.38	4.00	5.00	5.13	3.75	FSL-4000SK

## Ordering Codes

**ESB - \*\* HB - \*\* SM - 1 1**

<b>Null</b>	
Code	Description
	This code is always "1"

<b>First Size Code</b>	
Code	Port Size
07	¾"
10	1"
12	1¼"
15	1½"
20	2"
25	2½"
30	3"
40	4"
50	5" - Call
60	6" - Call

<b>Hose Barb Side</b>	
Code	Description
HB	Inch Barb (Standard)
HM	Metric Barb

Choose Adapter Size  
Replace \*\* with the desired adapter size.  
Two different size codes selects step size option.

<b>Second Size Code</b>	
Code	Port Size
07	¾"
10	1"
12	1¼"
15	1½"
20	2"
25	2½"
30	3"
40	4"
50	5" - Call
60	6" - Call

<b>Split Flange Side</b>	
Code	Description
SM	C.61 Split Flange Head

Metric Hose Barb Connection  
Adapters supplied in metric market locales use metric-barb IDs. Please call to confirm price and availability.

<b>Adapter Material</b>	
Code	Description
1	Low Carbon Steel
2	Stainless Steel

